

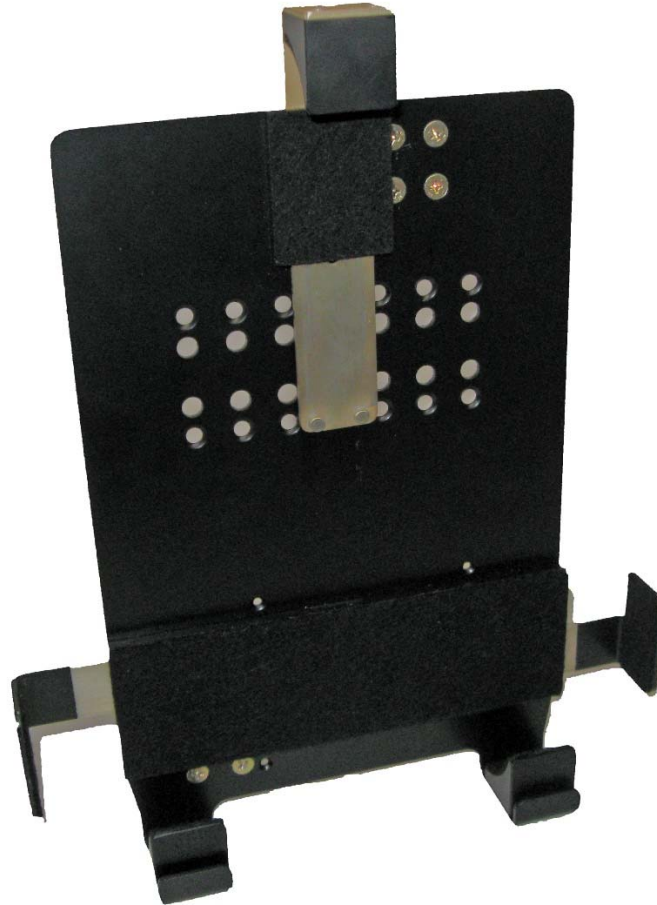

# Cradle – iPad Universal *Plus*

## Specification Sheet



**Part Number: 213014-10**

### Proprietary Notice

This document and the information disclosed herein are the proprietary data of Avionics Support Group, Inc. (ASG). The information contained herein shall NOT be reproduced, used, or disclosed partially or in full to others without the written authorization of Avionics Support Group, Inc.

**Description:** The Cradle – iPad Universal Plus is designed for use with the iPad 2, 3, 4 & Air with or without a Smart Case. The Cradle will also accommodate various other EFB Displays enabling its universal applicability. The Cradle provides a safe and secure platform for your EFB, while allowing access to all the ports.

**Benefits:**

RTCA DO160G: Section 7(B), 8(S)

Maximum display weight 6lbs/2.72155kg

Applicability: iPad 2, 3, 4 and Air (with or without a smart case) and Legacy EFB Displays

**Features:**

Dimensions - Open: 11.78" ( 30cm) L x 8.41" (21.36cm) W x 2.34" (5.94cm) D

Dimensions - Closed: 10.00" (25.4cm) L x 6.41" (16.28cm) W x 2.34" (5.94cm) D

Weight: 1.213LBs (0.550kg) - All Metal Construction

Powder Coated

Toggled Release and Secure Mechanism for easy mounting and removal

Pre-drilled for the cfMount™ and IPS

Designed to fit tightly around the EFB

Mounting Hole Location:

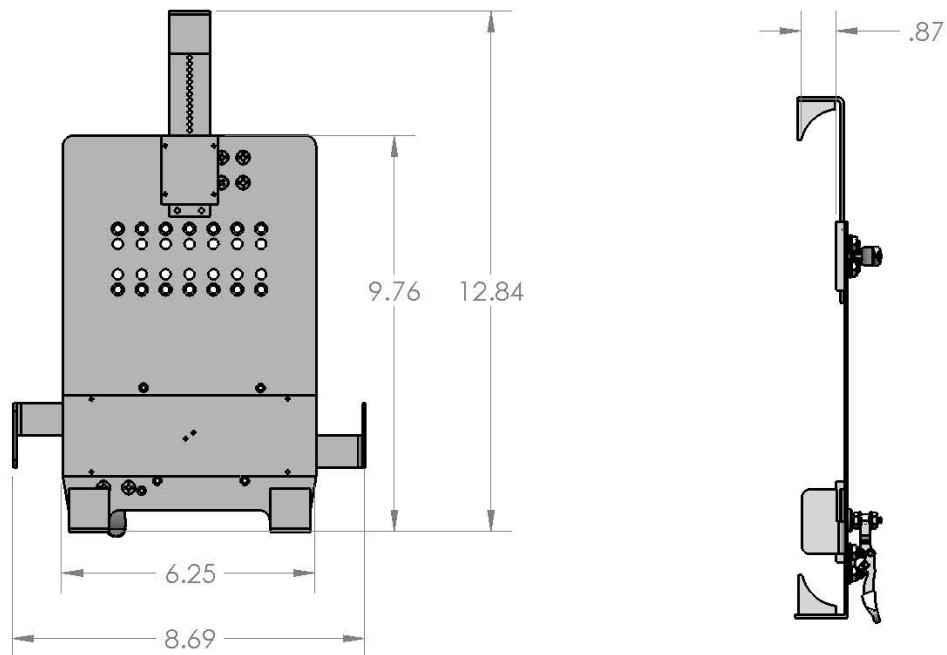

**Mounting Hardware:**

Screws: P/N: MS2464S49 (4ea)

Nuts: P/N: MS21042-3 (4ea)

Washers: P/N: AN960-10L (4ea)

Part Number 213014-10

Cradle with  
EFB/Display:



navAero Display:



iPad 4 with Smart  
Case:



iPad Air: